

## COOLING SYSTEM [SKYACTIV-G 2.5 (WITH CYLINDER DEACTIVATION)]

id0112q6002800

### Outline

- An engine coolant control valve has been adopted to improve fuel economy during low engine loads.

### Structural View

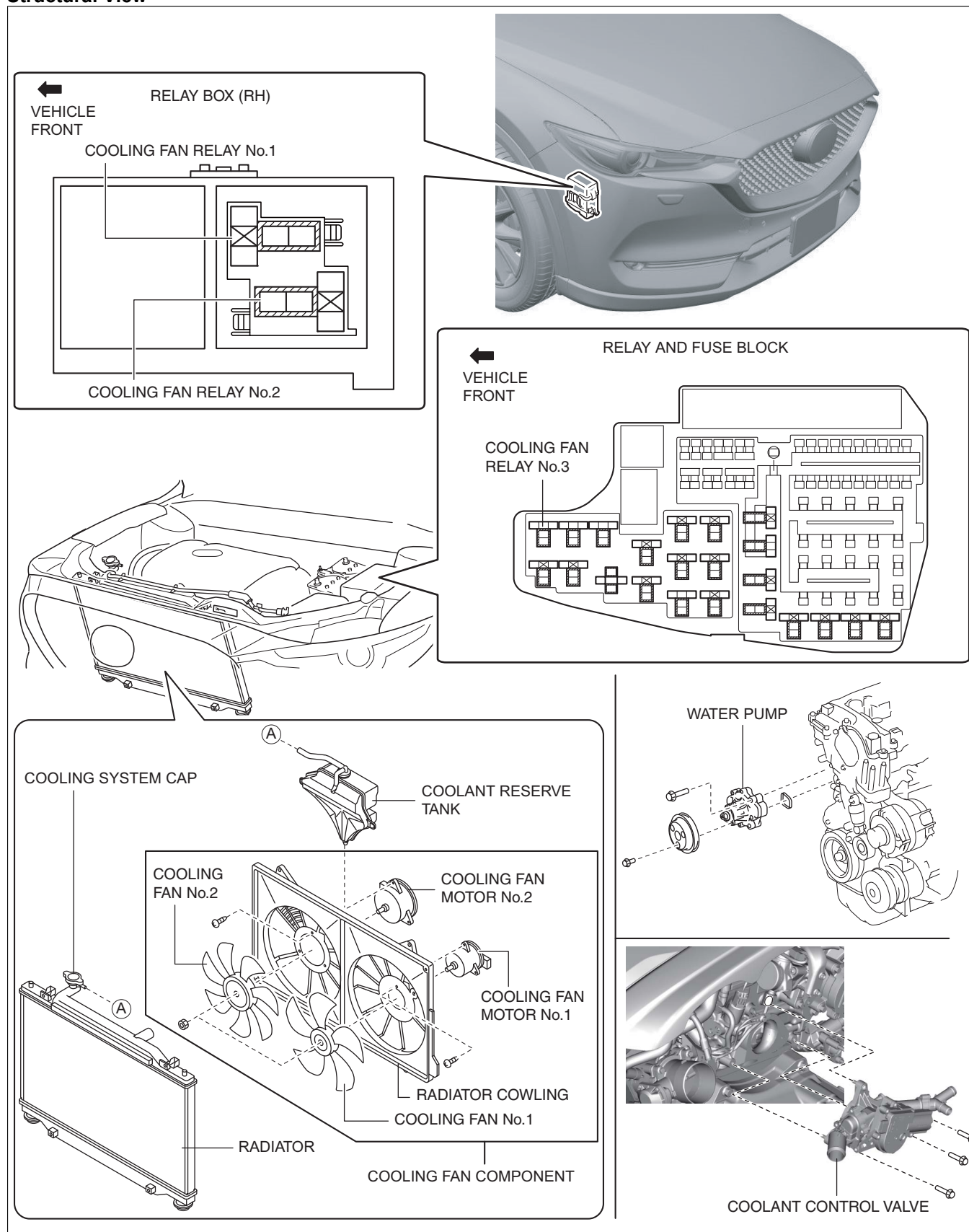

ac5wzn00004594

Flow Chart

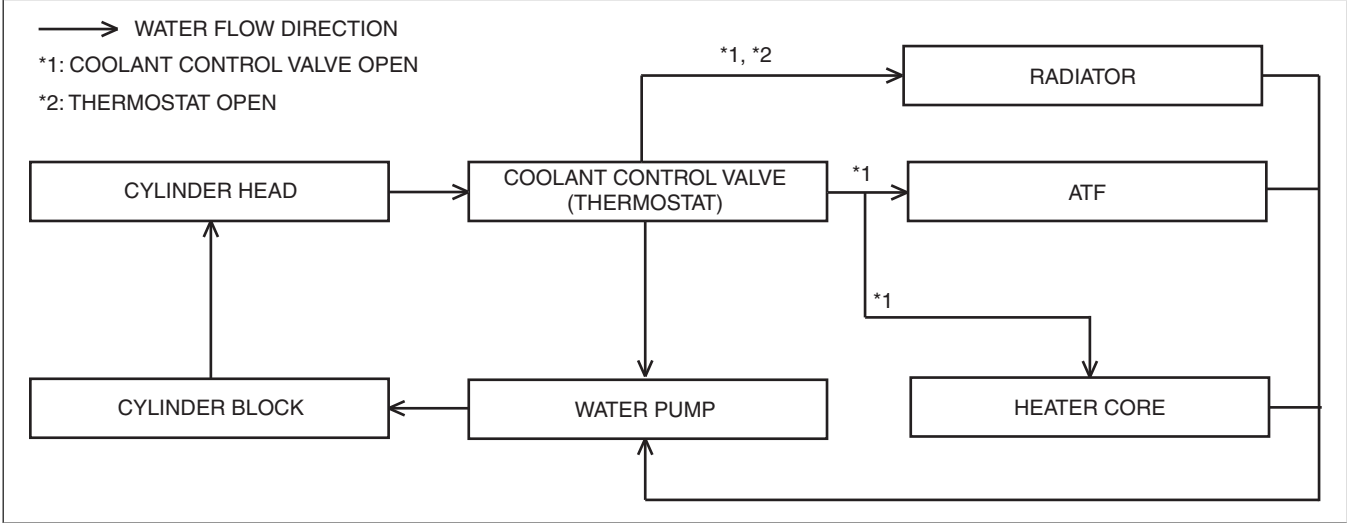

ac5wzn00004595

Structure

- Consists of the following parts:

Radiator	(See RADIATOR [SKYACTIV-G 2.5 (WITH CYLINDER DEACTIVATION)].)
Cooling system cap	(See COOLING SYSTEM CAP [SKYACTIV-G 2.5 (WITH CYLINDER DEACTIVATION)].)
Water pump	(See WATER PUMP [SKYACTIV-G 2.5 (WITH CYLINDER DEACTIVATION)].)
Cooling fan component	(See COOLING FAN COMPONENT [SKYACTIV-G 2.5 (WITH CYLINDER DEACTIVATION)].)
Cooling fan relay	(See COOLING FAN RELAY [SKYACTIV-G 2.5 (WITH CYLINDER DEACTIVATION)].)