

ADAPTIVE FRONT LIGHTING SYSTEM (AFS) LOCATION INDEX

id15200000700

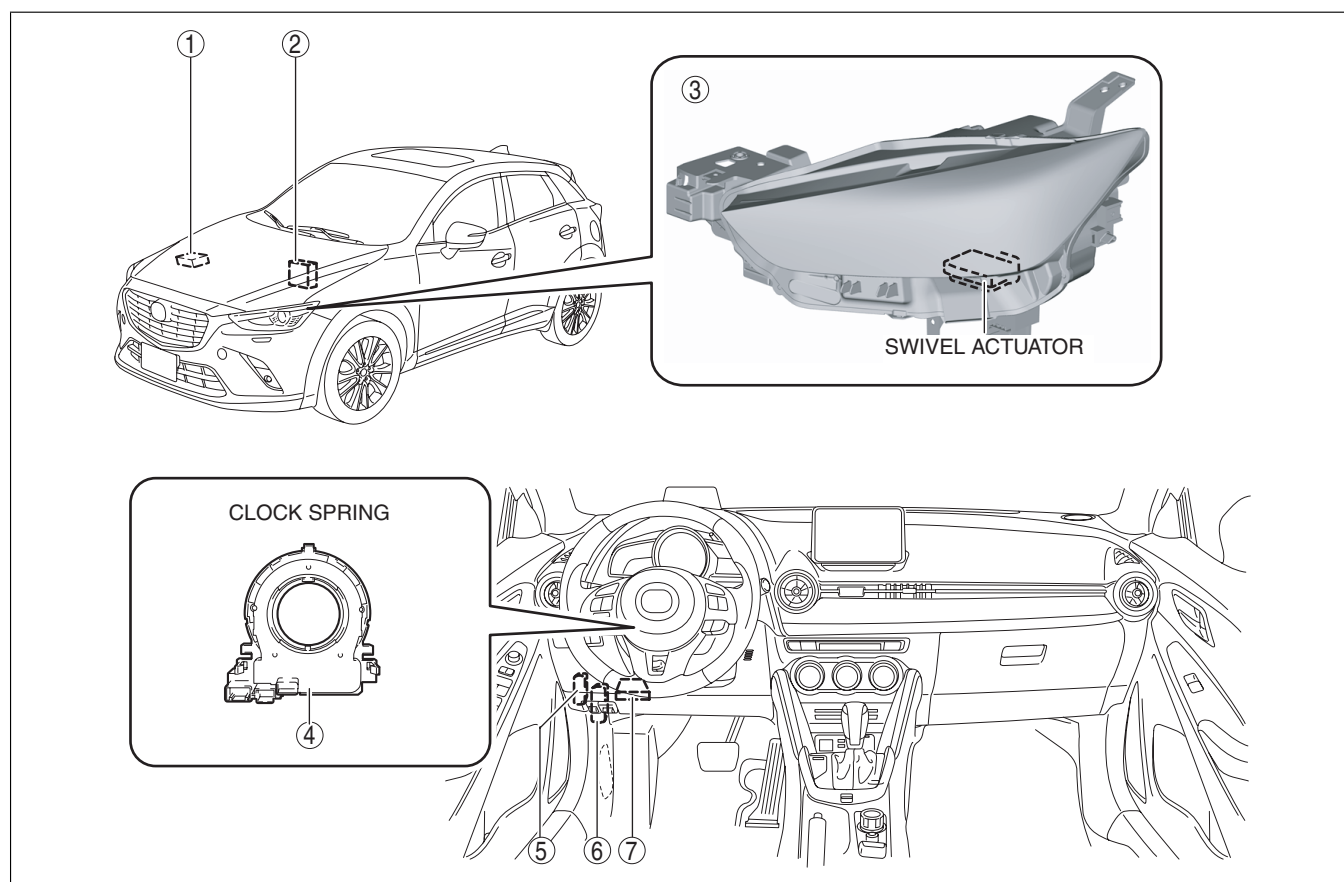

ac3wzw00001899

1	PCM (SKYACTIV-D 1.5) (See PCM REMOVAL/INSTALLATION [SKYACTIV-D 1.5].) (See PCM INSPECTION [SKYACTIV-D 1.5].) (See PCM CONFIGURATION (USING READ/WRITE FUNCTION) [SKYACTIV-D 1.5].) (See PCM CONFIGURATION (USING AS-BUILT DATA) [SKYACTIV-D 1.5].)	5	BCM (See BODY CONTROL MODULE (BCM) REMOVAL/INSTALLATION.) (See BODY CONTROL MODULE (BCM) INSPECTION.) (See BODY CONTROL MODULE (BCM) CONFIGURATION (USING READ/WRITE FUNCTION).)
2	PCM (SKYACTIV-G 2.0) (See PCM REMOVAL/INSTALLATION [SKYACTIV-G 2.0].) (See PCM INSPECTION [SKYACTIV-G 2.0].) (See PCM CONFIGURATION (USING READ/WRITE FUNCTION) [SKYACTIV-G 2.0].) (See PCM CONFIGURATION (USING AS-BUILT DATA) [SKYACTIV-G 2.0].)	6	AFS control module (See ADAPTIVE FRONT LIGHTING SYSTEM (AFS) CONTROL MODULE REMOVAL/INSTALLATION.) (See HEADLIGHT AUTO LEVELING SYSTEM INITIALIZATION.)
3	Front combination light (See FRONT COMBINATION LIGHT REMOVAL/INSTALLATION.) (See FRONT COMBINATION LIGHT DISASSEMBLY/ASSEMBLY.)	7	EPS control module (See STEERING WHEEL AND COLUMN REMOVAL/INSTALLATION.) (See EPS CONTROL MODULE INSPECTION.)
4	Steering angle sensor (See STEERING ANGLE SENSOR REMOVAL/INSTALLATION.) (See STEERING ANGLE SENSOR INSPECTION.)		